

008H008T1-MKS

CARRIAGE BOLT ANSI B18.5.2.1M-M8X1.25X70
30 pieces

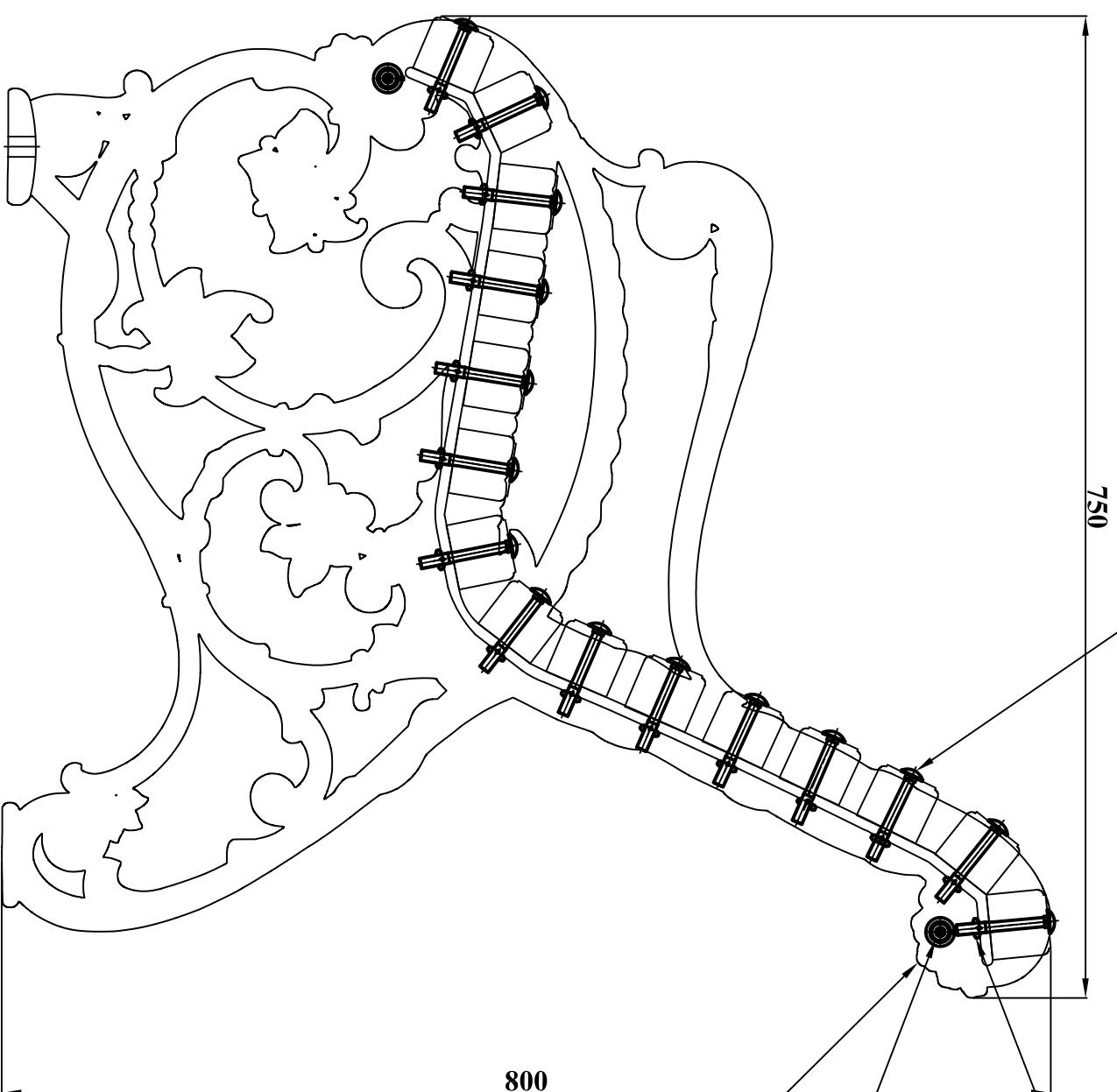

Nut DIN 439-M8x1.25
30 pieces

Hex Bolt ANSI B18.3.1MxM8x1.25x40
4 pieces

2 pc. Support
m=43.1 kg

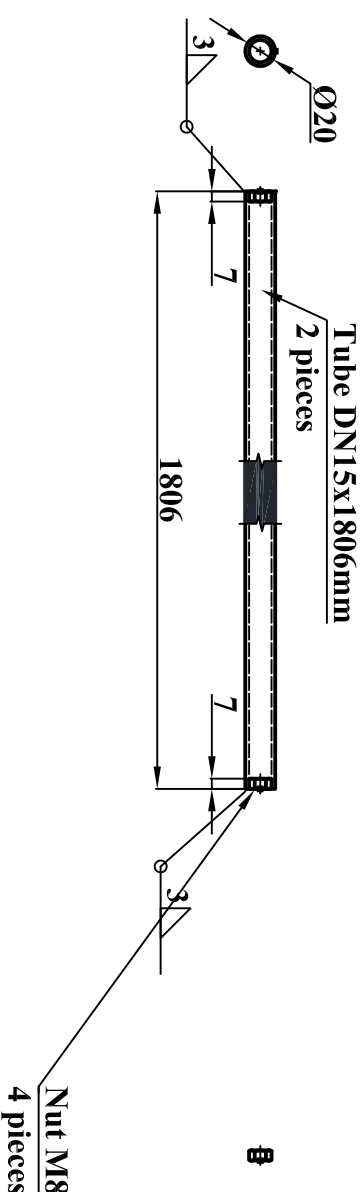
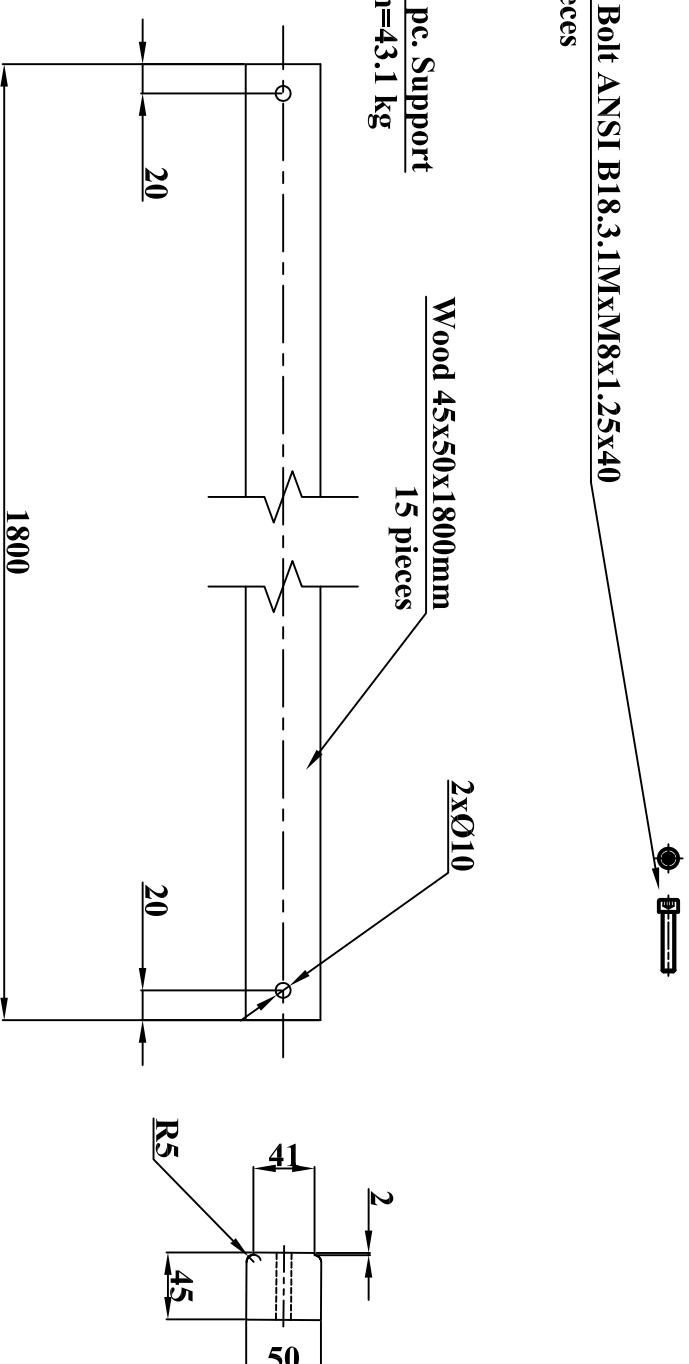

No.	Parts	Material	Mass (kg)	N
1	Support	0.6025 (EN-GJS-250)	43,1000	2
2	Tube DN15 x 1806 mm	CT 3	1,9300	2
3	Taxta 45x50x1800 mm	Beech's tree	2,2400	15
4	Hex Bolt M8x1.25x40 mm Nut M8x1.25	-	-	4
5	Carriage Bolt M8x1.25x70 mm	-	-	4
6	Nut DIN 439-M8x1.25	-	-	30
7				30

A

VIEW - A

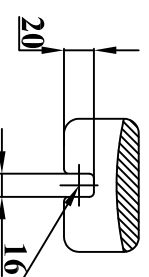

In both support must open cleft
for Bolt M14 to fix

SKM-L1800H800			Litter	Mass	Scale
Day. Sheet	Doc. №	Signature			
Drown	A.Ahmadov			120 kg	
Checked	E.Mustafayev		Sheet	Sheets	
Witnessed	N.Mukhtari				

Bench L1800H800

Beech's tree

**TECHNICAL EQUIPMENT
PLANT
DESIGNS SECTOR**